

CATALOG NUMBER	"A" INTERFACE
1B3C1-0503-01	FULL DETENT
1B5C1-0503-01	SMOOTH BORE

MATERIAL AND FINISH

GPPO HOUSING: CRES 303; PASSIVATED
 JACK HOUSING AND CENTER CONTACT: BeCu; GOLD PLATE 50-100 MICROINCHES OVER NICKEL PLATE 50 MICROINCHES MIN.
 DIELECTRICS: VIRGIN PTFE (TEFLON)

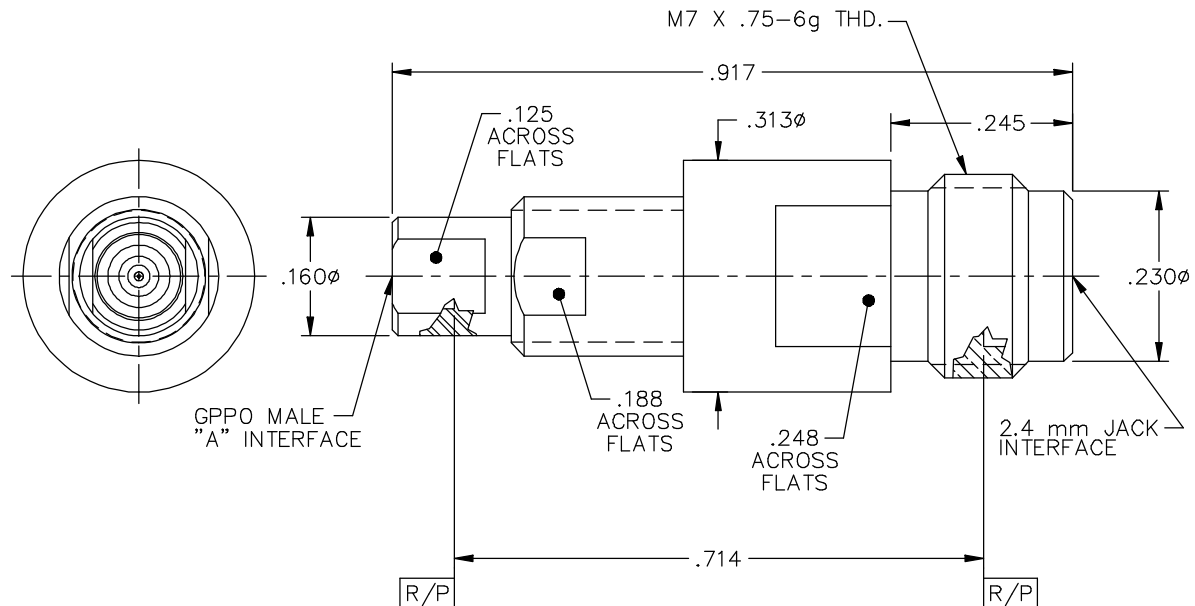
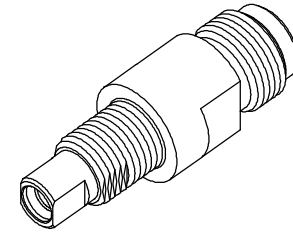

This drawing and any data contained herein is the property of Corning Gilbert Inc., and constitutes and contains proprietary and confidential information. Neither receipt nor possession of this drawing confers or transfers any right to duplicate, use or disclose any information contained herein except as expressly authorized by Corning Gilbert Inc.

GPPO MALE TO
2.4 mm JACK ADAPTER
(TAB DETENT)

IDENT CODE:
82316

REVISION: E

Corning Gilbert Inc.

SOURCE FILE: MECR# 2511

DWG. NO.: OL-1BXC1-0503-01

ASSY. PROC.: -